

559^W23

BY EMPIRICAL & CO

PENTHOUSE 12

3 Bedrooms / 2 Bathrooms
1,765 SqFt Interior
929 SqFt Exterior Terrace / Balcony

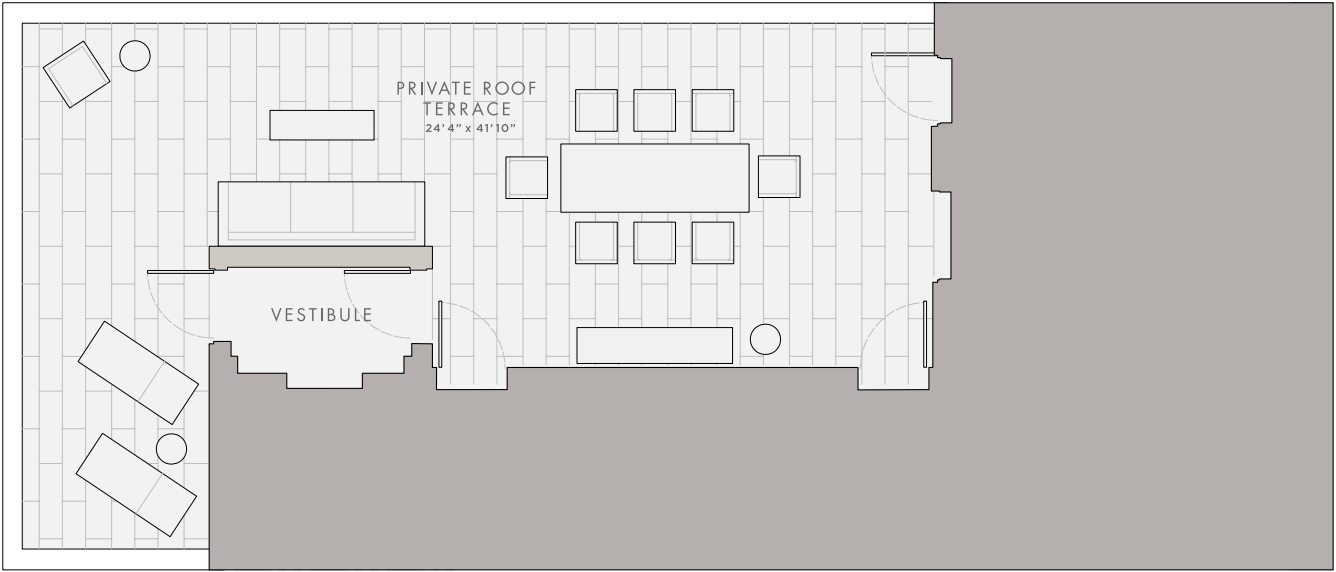

View from Penthouse Terrace

INTERIORS

- Duplex unit with private elevator access and interior stair case
- South facing double height loft-type living, dining, kitchen area with access to private terrace
- 18' tall floor to ceiling custom German curtain wall windows (by Schucko)
- Private roof terrace with outdoor kitchen
- 7" engineered European Oak long plank flooring
- Solid wood doors and sliding doors with Italian Valli & Valli hardware
- Master bedroom with 9' ceiling, balcony and dressing room

- Secondary bedrooms with walk-in closet
- Miele Washer & Dryer
- Multi-purpose utility closet

KITCHEN

- German manufactured custom kitchen cabinetry by Eggersmann
- Textured smoked oak and lacquered cabinet doors
- Honed Montclair Danby marble countertops and walls
- Miele appliances throughout: Double ovens, gas cooktop, hood ventilation, dishwasher

- Sub-Zero refrigeration and wine cooler
- Stainless steel sink and Italian faucet by Fantini

MASTER BATH

- Combination Montclair Danby marble slab and tile, white quartzite stone tile and large format Italian glass tile walls
- Montclair Danby marble tile floors
- Duravit bathtub with Montclair Danby marble slab deck and surrounds
- Spa-like features including shower stall with window and separate toilet room with wall hung toilet by Duravit
- Italian plumbing fixtures by Fantini

- Custom wood double vanity and 7' long mirror cabinet
- German Floor-to-ceiling window (by Schucko)

MAIN LEVEL BATH

- Combination Montclair Danby marble slab and tile, white quartzite stone tile and large format Italian glass tile walls
- Montclair Danby marble tile floors
- Wall hung toilet by Duravit
- Separate shower stall with Raindance shower
- German plumbing fixtures by Hansgrohe
- Custom wood vanity and 5-6' long mirror cabinet

PENTHOUSE 12

3 Bedrooms / 2 Bathrooms
1,765 SqFt Interior
929 SqFt Exterior Terrace / Balcony

PENTHOUSE 12 : UPPER LEVEL



PENTHOUSE 12 : MAIN LEVEL

